

Tools required: Rubber mallet

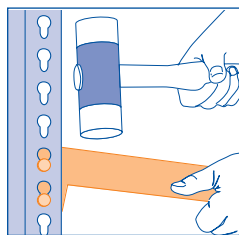

We advise the use of protective gloves and goggles, or eyeglasses when assembling this product.

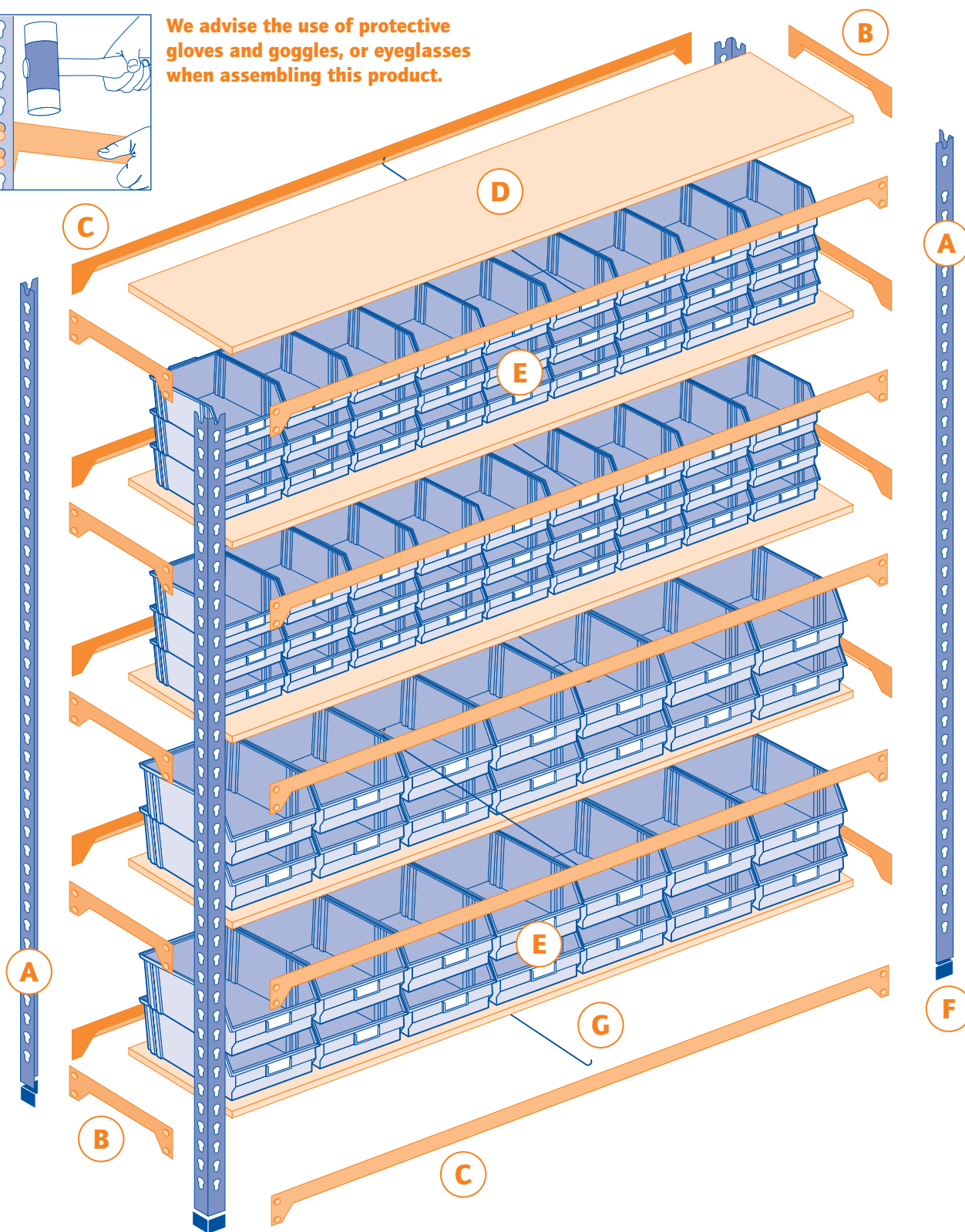

## ASSEMBLY

- 1 Fit plastic feet **F** to uprights **A**.
- 2 Assemble both ends first - **A** and **B** starting from the bottom. Allow 7 clear holes between each shelf support **B** for the first two entries then 9 clear holes for the top two entries.
- 3 Tap together using rubber mallet.
- 4 Join both ends using front and rear beams **C**. Add tie straps **G**.
- 5 Add shelves **D**.
- 6 Add boxes **E**.

## COMPONENTS

**A** Uprights  
4 of

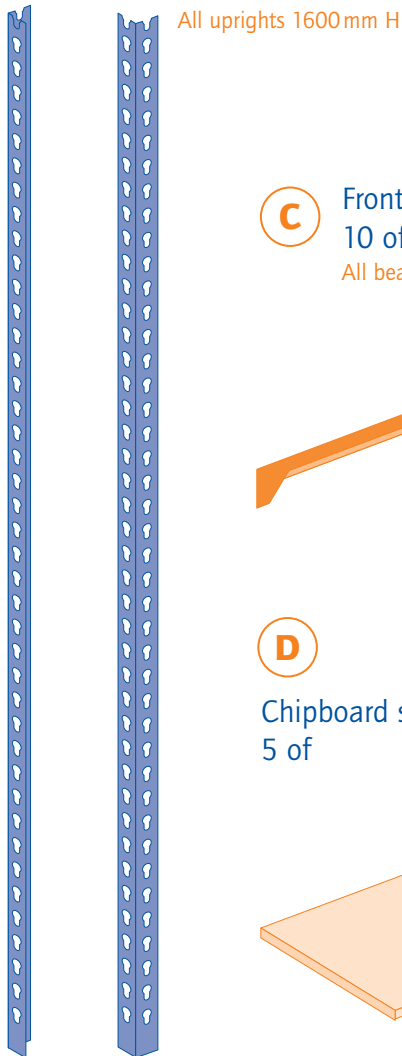

**B** Side beams  
10 of

All beams 305 mm D

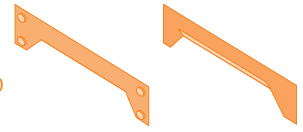

**C** Front and rear beams  
10 of

All beams 1525 mm W

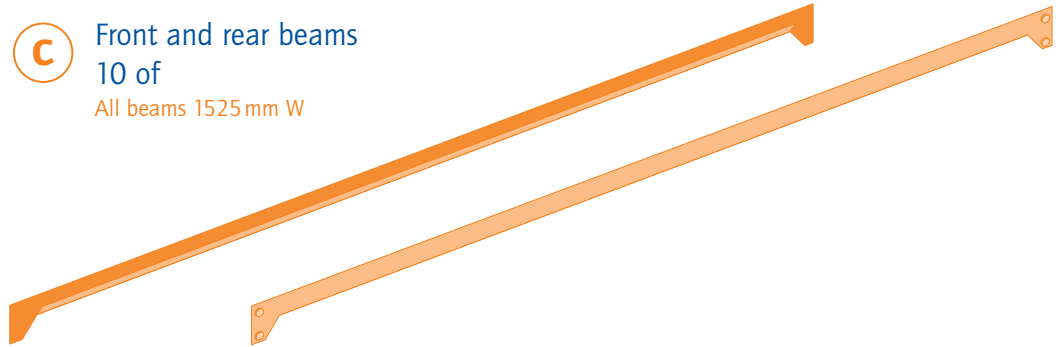

**D** Chipboard shelves  
5 of

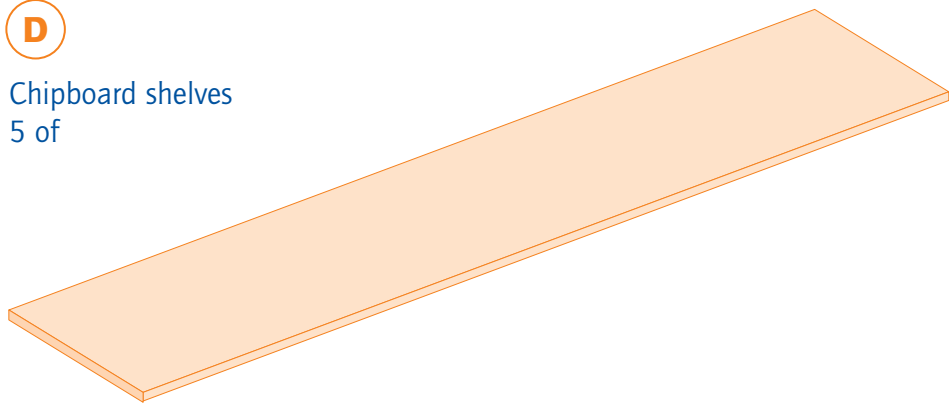

**E** Budget Bins  
88 of

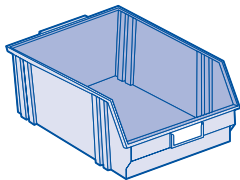

28 x PB104B/L &  
60 x PB103B/L

**F** Plastic feet  
4 of

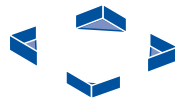

**G** Wire shelf tie straps

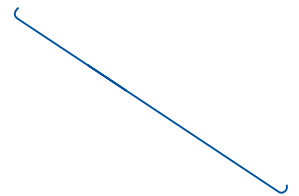

## SAFETY

					4 per Joint 
Keep heavier items on the bottom shelves		Keep your shelving dry	Do not climb on your shelving	Make sure it is on a level and even floor	Tie plates recommended with more than one bay