

Main illustration shows BBBAY36

Tools required: Rubber mallet

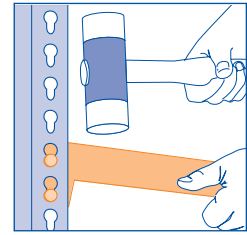

We advise the use of protective gloves and goggles, or eyeglasses when assembling this product.

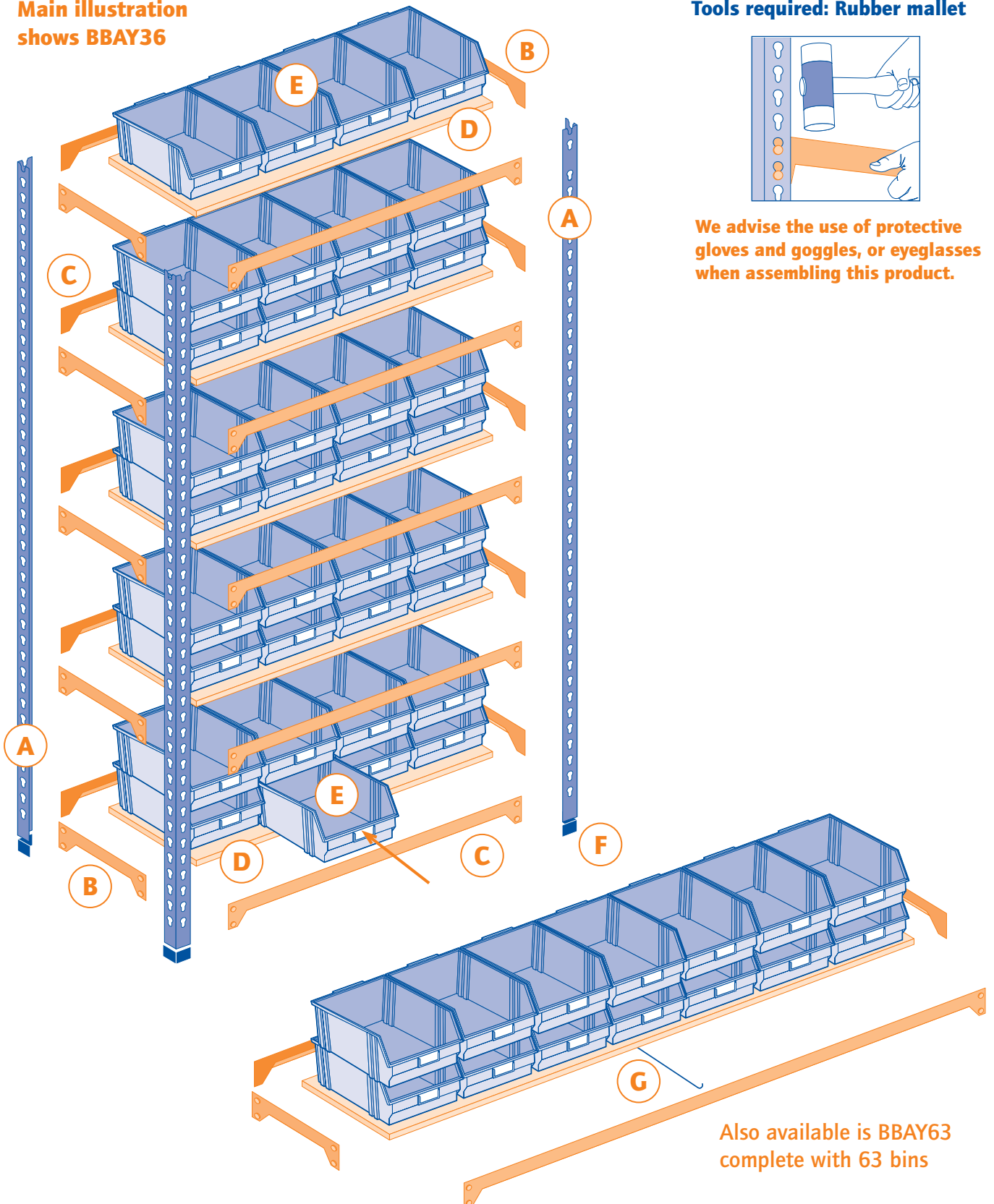

Also available is BBBAY63 complete with 63 bins

ASSEMBLY

- 1 Fit plastic feet **F** to uprights **A**.
- 2 Assemble both ends first - **A** and **B** starting from the bottom. Allow 8 clear holes between each shelf support **B**.
- 3 Tap together using rubber mallet.
- 4 Join both ends using front and rear beams **C**. Add tie straps **G** (for BBBAY63 only).
- 5 Add shelves **D**.
- 6 Add boxes **E**.

COMPONENTS

A Uprights
4 of

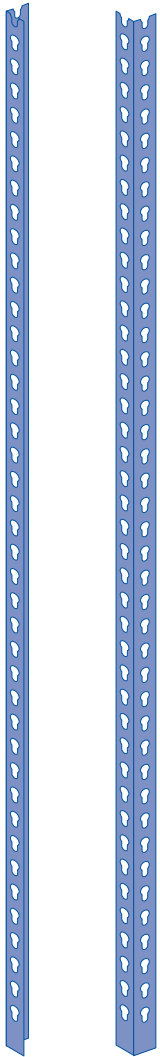

All uprights 1600 mm H

B Side beams
10 of

All beams 305 mm D

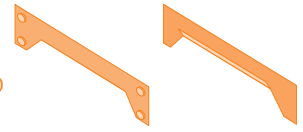

C Front and rear beams
10 of

All beams 915 mm
or 1525 mm W

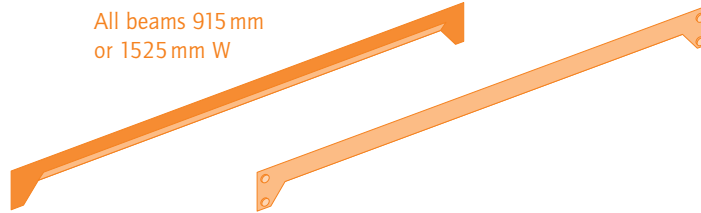

D Chipboard shelves
5 of

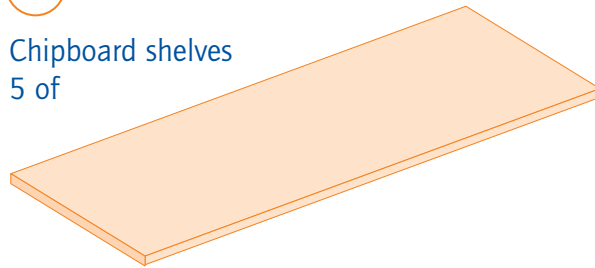

E Budget Bins PB104B/L
36 or 63

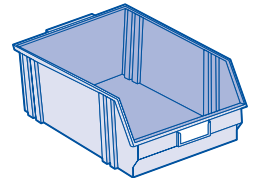

F Plastic feet
4 of

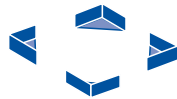

G Wire shelf tie straps
(for BBAY 63 only)

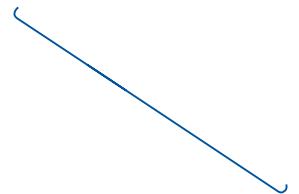

SAFETY

					<p>4 per Joint</p>
<p>Keep heavier items on the bottom shelves</p>		<p>Keep your shelving dry</p>	<p>Do not climb on your shelving</p>	<p>Make sure it is on a level and even floor</p>	<p>Tie plates recommended with more than one bay</p>