

# ASSEMBLY INSTRUCTIONS

TESTED TO



## Rapid2 SHELVING - MULTIPLE SIZES (MEDIUM DUTY)

### COMPONENTS

**A** Uprights (x4)



**B** Side beams (2 per shelf level)

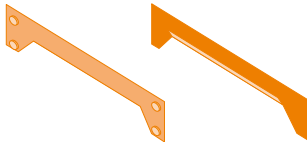

**C** Front and rear beams (2 per shelf level)

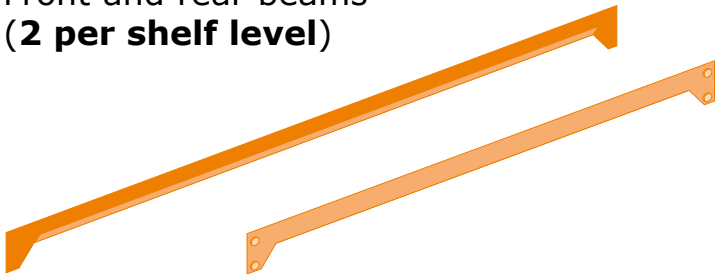

**D** Shelves (1 per shelf level, widths and depths to suit beam)

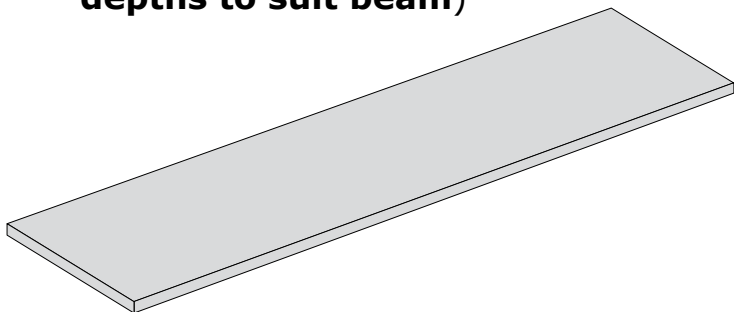

**E** Plastic feet (x4)

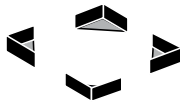

### SAFETY

						 x4
	Keep heavier items on the bottom shelves.	Keep your shelving dry.	Do not climb on your shelving.	Make sure it is on a level and even floor.	Tie plates recommended with more than one bay.	

If you have any problems with this product or its assembly, please contact The Rapid Racking Team on **01285 686868** for help and advice.

## ASSEMBLY - MULTIPLE SIZES

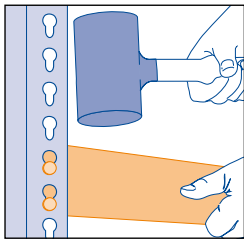

### Safety advice:

We advise you wear protective gloves when assembling this product.

**Tools required:** Rubber mallet.

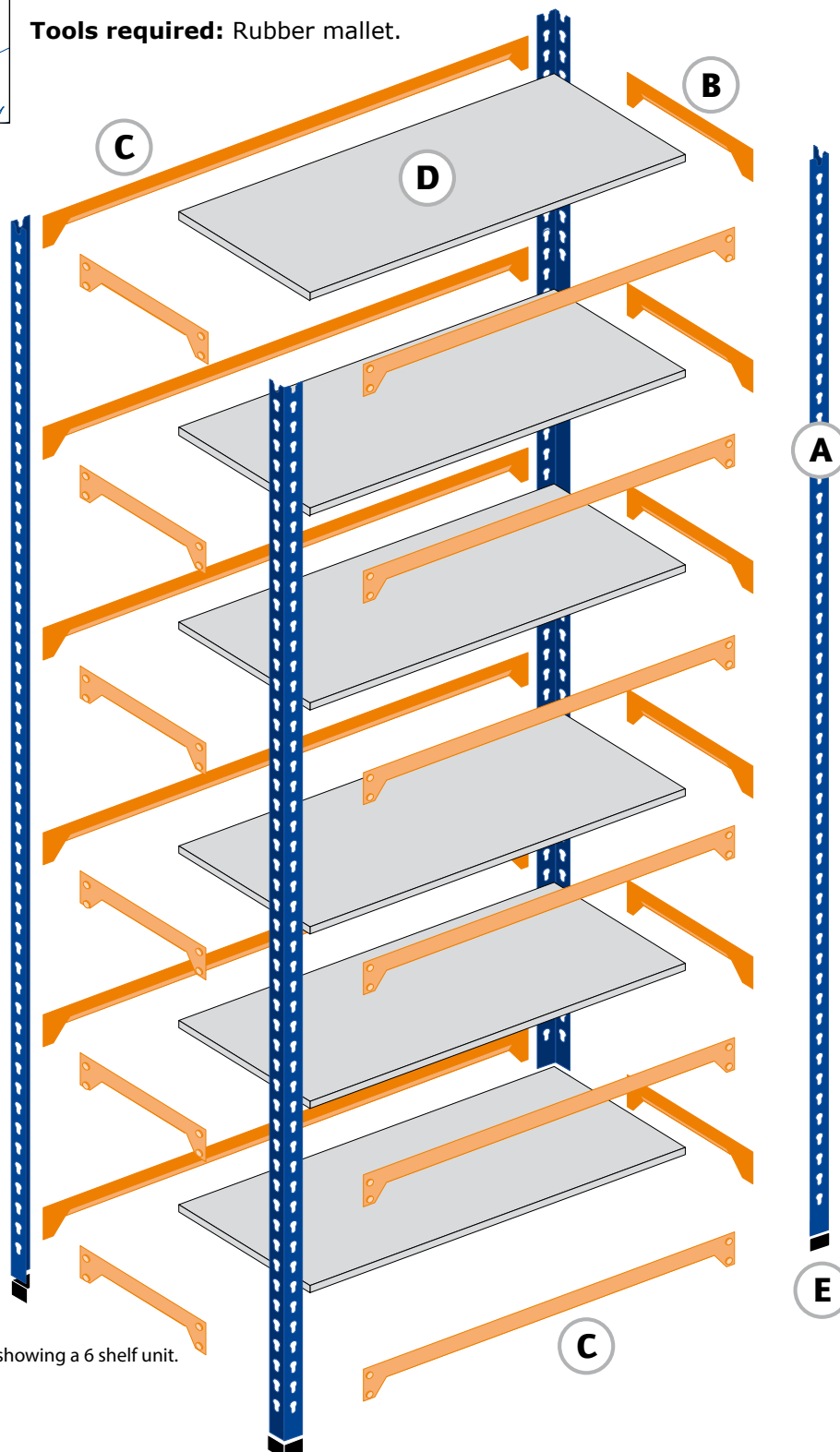

Illustration showing a 6 shelf unit.

1. Fit plastic feet **E** to uprights **A**.
2. Assemble both ends first (**A** and **B**) using the rubber mallet and starting from the bottom.
4. Join both ends using front and rear beams **C**.
5. Add shelves **D**.

**Keyhole slots along the uprights allow beams to slot into place.**

